

# APPENDIX A

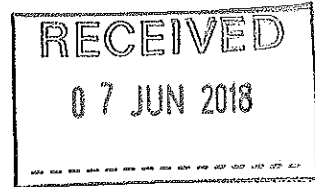

## Application for a premises licence to be granted under the Licensing Act 2003

### PLEASE READ THE FOLLOWING INSTRUCTIONS FIRST

Before completing this form please read the guidance notes at the end of the form. If you are completing this form by hand please write legibly in block capitals. In all cases ensure that your answers are inside the boxes and written in black ink. Use additional sheets if necessary.

You may wish to keep a copy of the completed form for your records.

I/We Rinneroon Ltd

*(Insert name(s) of applicant)*

apply for a premises licence under section 17 of the Licensing Act 2003 for the premises described in Part 1 below (the premises) and I/we are making this application to you as the relevant licensing authority in accordance with section 12 of the Licensing Act 2003

#### Part 1 – Premises details

Postal address of premises or, if none, ordnance survey map reference or description			
130 Druid Street			
Post town	London	Postcode	SE1 2HH

Telephone number at premises (if any)	
Non-domestic rateable value of premises	£ 18,250

#### Part 2 - Applicant details

Please state whether you are applying for a premises licence as      Please tick as appropriate

- |  |                                     |                             |
|--|-------------------------------------|-----------------------------|
| a) an individual or individuals *                    | <input type="checkbox"/>            | please complete section (A) |
| b) a person other than an individual *               |                                     |                             |
| i as a limited company/limited liability partnership | <input checked="" type="checkbox"/> | please complete section (B) |
| ii as a partnership (other than limited liability)   | <input type="checkbox"/>            | please complete section (B) |
| iii as an unincorporated association or              | <input type="checkbox"/>            | please complete section (B) |
| iv other (for example a statutory corporation)       | <input type="checkbox"/>            | please complete section (B) |
| c) a recognised club                                 | <input type="checkbox"/>            | please complete section (B) |
| d) a charity   | <input type="checkbox"/>            | please complete section (B) |

- e) the proprietor of an educational establishment ☐ please complete section (B)
- f) a health service body ☐ please complete section (B)
- g) a person who is registered under Part 2 of the Care Standards Act 2000 (c14) in respect of an independent hospital in Wales ☐ please complete section (B)
- ga) a person who is registered under Chapter 2 of Part 1 of the Health and Social Care Act 2008 (within the meaning of that Part) in an independent hospital in England ☐ please complete section (B)
- h) the chief officer of police of a police force in England and Wales ☐ please complete section (B)

\* If you are applying as a person described in (a) or (b) please confirm (by ticking yes to one box below):

- I am carrying on or proposing to carry on a business which involves the use of the premises for licensable activities; or ☐
- I am making the application pursuant to a statutory function or ☐
- a function discharged by virtue of Her Majesty's prerogative ☐

**(A) INDIVIDUAL APPLICANTS** (fill in as applicable)

Mr <input type="checkbox"/>	Mrs <input type="checkbox"/>	Miss <input type="checkbox"/>	Ms <input type="checkbox"/>	Other Title (for example, Rev)	
Surname			First names		
Date of birth		I am 18 years old or over <input type="checkbox"/>		Please tick yes	
Nationality					
Current residential address if different from premises address					
Post town				Postcode	
Daytime contact telephone number					
E-mail address (optional)					

**SECOND INDIVIDUAL APPLICANT** (if applicable)

Mr <input type="checkbox"/>	Mrs <input type="checkbox"/>	Miss <input type="checkbox"/>	Ms <input type="checkbox"/>	Other Title (for example, Rev)	
Surname			First names		

<b>Date of birth</b>		I am 18 years old or over <input type="checkbox"/> Please tick yes	
<b>Nationality</b>			
Current postal address if different from premises address			
Post town		Postcode	
<b>Daytime contact telephone number</b>			
<b>E-mail address (optional)</b>			

### (B) OTHER APPLICANTS

Please provide name and registered address of applicant in full. Where appropriate please give any registered number. In the case of a partnership or other joint venture (other than a body corporate), please give the name and address of each party concerned.

<b>Name</b> Rinneroon Ltd
<b>Address</b>  130 Druid Street London SE1 2HH
<b>Registered number (where applicable)</b> 11400196
<b>Description of applicant (for example, partnership, company, unincorporated association etc.)</b>  We are a ltd company that run London's largest free running club and community.
<b>Telephone number (if any)</b>
<b>E-mail address (optional)</b>

### Part 3 Operating Schedule

When do you want the premises licence to start? 8.6.2018

If you wish the licence to be valid only for a limited period, when do you want it to end?

DD	MM	YYYY
<input type="text"/>	<input type="text"/>	<input type="text"/>

Please give a general description of the premises (please read guidance note 1)

This is a Network Rail archway on Druid Street not far from Tower Bridge. It currently is completely empty other than one disused toilet. There is a small area outside the premises on the road that other businesses nearby have cordoned off for outside space.

The archway will be turned into a home for our community led running club that has been going for 9 years. We've won various awards for volunteering. We'll store merchandise, have an office space, and have a section where running related foods and beverages can be sold.

If 5,000 or more people are expected to attend the premises at any one time, please state the number expected to attend.

N/A

What licensable activities do you intend to carry on from the premises?

(please see sections 1 and 14 and Schedules 1 and 2 to the Licensing Act 2003)

Provision of regulated entertainment (please read guidance note 2)

Please tick all that apply

- |   |                          |
|---|--------------------------|
| a) plays (if ticking yes, fill in box A)  | <input type="checkbox"/> |
| b) films (if ticking yes, fill in box B)  | <input type="checkbox"/> |
| c) indoor sporting events (if ticking yes, fill in box C)   | <input type="checkbox"/> |
| d) boxing or wrestling entertainment (if ticking yes, fill in box D)  | <input type="checkbox"/> |
| e) live music (if ticking yes, fill in box E)   | <input type="checkbox"/> |
| f) recorded music (if ticking yes, fill in box F)   | <input type="checkbox"/> |
| g) performances of dance (if ticking yes, fill in box G)  | <input type="checkbox"/> |
| h) anything of a similar description to that falling within (e), (f) or (g) (if ticking yes, fill in box H) | <input type="checkbox"/> |

**Provision of late night refreshment** (if ticking yes, fill in box I)

☐

**Supply of alcohol** (if ticking yes, fill in box J)

x

**In all cases complete boxes K, L and M**

A

<b>Plays</b> Standard days and timings (please read guidance note 7)			<b><u>Will the performance of a play take place indoors or outdoors or both – please tick</u></b> (please read guidance note 3)		Indoors <input type="checkbox"/>
					Outdoors <input type="checkbox"/>
					Both <input type="checkbox"/>
Day	Start	Finish	<b><u>Please give further details here</u></b> (please read guidance note 4)		
Mon					
Tue					
			<b><u>State any seasonal variations for performing plays</u></b> (please read guidance note 5)		
Wed					
Thur					
			<b><u>Non standard timings. Where you intend to use the premises for the performance of plays at different times to those listed in the column on the left, please list</u></b> (please read guidance note 6)		
Fri					
Sat					
Sun					

# B

<b>Films</b> Standard days and timings (please read guidance note 7)			<b>Will the exhibition of films take place indoors or outdoors or both – please tick</b> (please read guidance note 3)	Indoors	<input type="checkbox"/>
				Outdoors	<input type="checkbox"/>
				Both	<input type="checkbox"/>
Day	Start	Finish			
Mon			<b>Please give further details here</b> (please read guidance note 4)		
Tue					
Wed.			<b>State any seasonal variations for the exhibition of films</b> (please read guidance note 5)		
Thur					
Fri			<b>Non standard timings. Where you intend to use the premises for the exhibition of films at different times to those listed in the column on the left, please list</b> (please read guidance note 6)		
Sat					
Sun					

C

<b>Indoor sporting events</b> Standard days and timings (please read guidance note 7)			<b><u>Please give further details</u></b> (please read guidance note 4)
Day	Start	Finish	
Mon			
Tue			<b><u>State any seasonal variations for indoor sporting events</u></b> (please read guidance note 5)
Wed			
Thur			<b><u>Non standard timings. Where you intend to use the premises for indoor sporting events at different times to those listed in the column on the left, please list</u></b> (please read guidance note 6)
Fri			
Sat			
Sun			



# D

<b>Boxing or wrestling entertainments</b> Standard days and timings (please read guidance note 7)			<b><u>Will the boxing or wrestling entertainment take place indoors or outdoors or both – please tick</u></b> (please read guidance note 3)		Indoors	<input type="checkbox"/>
					Outdoors	<input type="checkbox"/>
					Both	<input type="checkbox"/>
Day	Start	Finish				
Mon			<b><u>Please give further details here</u></b> (please read guidance note 4)			
Tue						
Wed			<b><u>State any seasonal variations for boxing or wrestling entertainment</u></b> (please read guidance note 5)			
Thur						
Fri			<b><u>Non standard timings. Where you intend to use the premises for boxing or wrestling entertainment at different times to those listed in the column on the left, please list</u></b> (please read guidance note 6)			
Sat						
Sun						

# E

<b>Live music</b> Standard days and timings (please read guidance note 7)			<b><u>Will the performance of live music take place indoors or outdoors or both – please tick</u></b> (please read guidance note 3)		Indoors	<input type="checkbox"/>
					Outdoors	<input type="checkbox"/>
					Both	<input type="checkbox"/>
Day	Start	Finish	<b><u>Please give further details here</u></b> (please read guidance note 4)			
Mon						
Tue						
			<b><u>State any seasonal variations for the performance of live music</u></b> (please read guidance note 5)			
Wed						
Thur						
			<b><u>Non standard timings. Where you intend to use the premises for the performance of live music at different times to those listed in the column on the left, please list</u></b> (please read guidance note 6)			
Fri						
Sat						
Sun						

# F

<b>Recorded music</b> Standard days and timings (please read guidance note 7)			<b>Will the playing of recorded music take place indoors or outdoors or both – please tick</b> (please read guidance note 3)		Indoors	<input type="checkbox"/>
					Outdoors	<input type="checkbox"/>
Day	Start	Finish			Both	<input type="checkbox"/>
Mon			<b>Please give further details here</b> (please read guidance note 4)			
Tue						
Wed			<b>State any seasonal variations for the playing of recorded music</b> (please read guidance note 5)			
Thur						
Fri			<b>Non standard timings. Where you intend to use the premises for the playing of recorded music at different times to those listed in the column on the left, please list</b> (please read guidance note 6)			
Sat						
Sun						

# G

<b>Performances of dance</b> Standard days and timings (please read guidance note 7)			<b>Will the performance of dance take place indoors or outdoors or both – please tick</b> (please read guidance note 3)	Indoors	<input type="checkbox"/>
				Outdoors	<input type="checkbox"/>
				Both	<input type="checkbox"/>
Day	Start	Finish	<b>Please give further details here</b> (please read guidance note 4)		
Mon					
Tue					
Wed			<b>State any seasonal variations for the performance of dance</b> (please read guidance note 5)		
Thur					
Fri					
Sat			<b>Non standard timings. Where you intend to use the premises for the performance of dance at different times to those listed in the column on the left, please list</b> (please read guidance note 6)		
Sun					

# H

<b>Anything of a similar description to that falling within (e), (f) or (g)</b> Standard days and timings (please read guidance note 7)			Please give a description of the type of entertainment you will be providing		
Day	Start	Finish	<b><u>Will this entertainment take place indoors or outdoors or both – please tick</u></b> (please read guidance note 3)	Indoors	<input type="checkbox"/>
Mon				Outdoors	<input type="checkbox"/>
				Both	<input type="checkbox"/>
Tue			<b><u>Please give further details here</u></b> (please read guidance note 4)		
Wed					
Thur			<b><u>State any seasonal variations for entertainment of a similar description to that falling within (e), (f) or (g)</u></b> (please read guidance note 5)		
Fri					
Sat			<b><u>Non standard timings. Where you intend to use the premises for the entertainment of a similar description to that falling within (e), (f) or (g) at different times to those listed in the column on the left, please list</u></b> (please read guidance note 6)		
Sun					



# I

<b>Late night refreshment</b> Standard days and timings (please read guidance note 7)			<b>Will the provision of late night refreshment take place indoors or outdoors or both – please tick</b> (please read guidance note 3)	Indoors	<input type="checkbox"/>
				Outdoors	<input type="checkbox"/>
				Both	<input type="checkbox"/>
Day	Start	Finish			
Mon			<b><u>Please give further details here</u></b> (please read guidance note 4)		
Tue					
Wed			<b><u>State any seasonal variations for the provision of late night refreshment</u></b> (please read guidance note 5)		
Thur					
Fri			<b><u>Non standard timings. Where you intend to use the premises for the provision of late night refreshment at different times, to those listed in the column on the left, please list</u></b> (please read guidance note 6)		
Sat					
Sun					

**J**

<b>Supply of alcohol</b> Standard days and timings (please read guidance note 7)			<b>Will the supply of alcohol be for consumption – please tick</b> (please read guidance note 8)	On the premises	<input checked="" type="checkbox"/>
				Off the premises	<input type="checkbox"/>
				Both	
Day	Start	Finish	<b>State any seasonal variations for the supply of alcohol</b> (please read guidance note 5)		
Mon	12:00	23:00			
Tue	12:00	23:00			
Wed	12:00	23:00			
Thur	12:00	23:00			
			<b>Non standard timings. Where you intend to use the premises for the supply of alcohol at different times to those listed in the column on the left, please list</b> (please read guidance note 6)		
Fri	12:00	23:00			
Sat	12:00	23:00			
Sun	12:00	23:00			

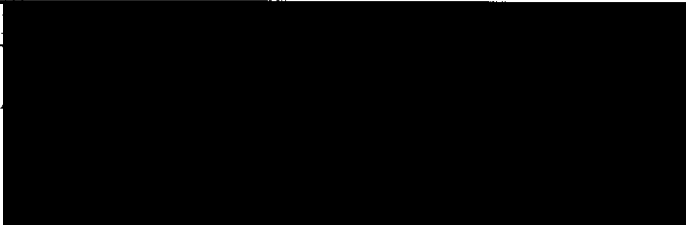
**State the name and details of the individual whom you wish to specify on the licence as designated premises supervisor (Please see declaration about the entitlement to work in the checklist at the end of the form):**

Name	
Tim Jones	
	
Postcode	
Personal licence number (if known)	
	
Issuing licensing authority (if known)	
BIIAB APLH Level 2 Award for Personal Licence Holders	



K

Please highlight any adult entertainment or services, activities, other entertainment or matters ancillary to the use of the premises that may give rise to concern in respect of children (please read guidance note 9).

N/A

L

Hours premises are open to the public Standard days and timings (please read guidance note 7).			State any seasonal variations (please read guidance note 5)
Day	Start	Finish	
Mon	12:00	23:00	<b>Non standard timings. Where you intend the premises to be open to the public at different times from those listed in the column on the left, please list</b> (please read guidance note 6)
Tue	12:00	23:00	
Wed	12:00	23:00	
Thur	12:00	23:00	
Fri	12:00	23:00	
Sat	12:00	23:00	
Sun	11:00	23:00	



**M** Describe the steps you intend to take to promote the four licensing objectives:

**a) General – all four licensing objectives (b, c, d and e) (please read guidance note 10)**

The venue's purpose is to house our running club which has been going for over 8 years. The emphasis therefore is promoting free exercise and giving advice and help to our thriving running community. We've won 3 awards for volunteering and are supported by MP Neil Coyle as we were by his predecessor Simon Hughes. We've also featured recently on BBC breakfast promoting our Couch to 5k programme, as well as on ITV news and the local press. All of this makes us quite unlike any of the breweries and establishments nearby which we feel will help us provide something new in the area promoting health and wellbeing.

We have been meeting in other venues along Druid Street for many years, and therefore are not going to be increasing the volume of people visiting the area once our venue opens. For over a year we have been meeting within 100 feet of the new venue in a nearby pub without any complaint from nearby residents.

As a long established club, we already have terms and conditions to ensure that the safety and welfare of the public is protected. We revoke membership of the club to anyone who behaves non-respectfully to other members, the venue staff, or members of the public. Over the years this has happened very rarely and we have a community of long-established members, many of whom are well-respected professionals and members of the local community. A number of our members live in the housing estate directly opposite the venue.

The venue will also serve and be visited by members of the public outside of our main club session times, but they would be in the minority and are expected to observe our rules in relation to the license objectives.

Very few of our runners smoke so there should not be a need for large numbers to continually congregate outside. In warmer weather some runners may stand in the outside space on Druid Street next to the road, but we will make sure this number is always low and we'll ensure that it is cordoned off and that the number of people never exceeds 30. SIA staff will be employed if necessary to make sure that the number doesn't go over x25 in order to give us a buffer.

Often we will have running related workshops within the arch, but these will be ticketed to limit numbers and will not be heard from the outside of the venue. We give water to our members on running nights and these will be served in recyclable cups with our logo. All bottles and refuse will be disposed of very quietly and before 10pm at night.

All staff will be trained to enforce Challenge 25 and to use the incident log in case of any incidents.

Any music will just be ambient music kept at low volume. Tuesday is our busiest night of the week and usually almost all runners have left the venue by 9.30pm

**b) The prevention of crime and disorder**

CCTV will be put on the premises both at the counter and the entrance to the property. The staff will be trained to look out for any suspicious activity and if crimes are suspected this will be reported to the police.

**c) Public safety**

If at any point a member of staff sees a customer who appears to be intoxicated they will immediately inform the duty manager. Service will be refused should they try to buy another drink. The duty manager will ask them politely to leave explaining that it's not personal but it's for professional reasons. They will also be offered water. If they become unruly they will be asked to leave the premises and on all occasions this will be recorded in the service log.

Glassware will be regularly collected from inside and outside the area and any broken glass swept up and disposed of immediately. We will also conduct regular head counts inside and outside the property every half an hour. We'll have all the relevant fire and safety notices in place.

**d) The prevention of public nuisance**

Any patrons inside who are causing nuisance by shouting, chanting or causing trouble which could cause annoyance to nearby residents will be asked to keep the noise down. If they ignore this then they will be reported to the duty manager and they will be asked to leave. The incident will be recorded in an incident log. We'll add posters on drinking and driving in the toilets and drink aware posters.

**e) The protection of children from harm**

Membership of our running club is only open to adults over the age of 18. Children do occasionally visit the club but always accompanied by a parent/guardian and under no circumstances would ever be served alcohol.

We will use challenge 25 to prevent anyone under the age of 18 buying or consuming alcohol. Staff will be trained to recognise the internationally recognised IDs and will check the photos and dates.

**Checklist:**

**Please tick to indicate agreement**

- I have made or enclosed payment of the fee. x
- I have enclosed the plan of the premises. x
- I have sent copies of this application and the plan to responsible authorities and others where applicable. x
- I have enclosed the consent form completed by the individual I wish to be designated premises supervisor, if applicable. x
- I understand that I must now advertise my application. x
- I understand that if I do not comply with the above requirements my application will be rejected. x
- [Applicable to all individual applicants, including those in a partnership which is not a limited liability partnership, but not companies or limited liability partnerships] I have included documents demonstrating my entitlement to work in the United Kingdom (please read note 15). x

IT IS AN OFFENCE, UNDER SECTION 158 OF THE LICENSING ACT 2003, TO MAKE A FALSE STATEMENT IN OR IN CONNECTION WITH THIS APPLICATION. THOSE WHO MAKE A FALSE STATEMENT MAY BE LIABLE ON SUMMARY CONVICTION TO A FINE OF ANY AMOUNT.

IT IS AN OFFENCE UNDER SECTION 24B OF THE IMMIGRATION ACT 1971 FOR A PERSON TO WORK WHEN THEY KNOW, OR HAVE REASONABLE CAUSE TO BELIEVE, THAT THEY ARE DISQUALIFIED FROM DOING SO BY REASON OF THEIR IMMIGRATION STATUS. THOSE WHO EMPLOY AN ADULT WITHOUT LEAVE OR WHO IS SUBJECT TO CONDITIONS AS TO EMPLOYMENT WILL BE LIABLE TO A CIVIL PENALTY UNDER SECTION 15 OF THE IMMIGRATION, ASYLUM AND NATIONALITY ACT 2006 AND PURSUANT TO SECTION 21 OF THE SAME ACT, WILL BE COMMITTING AN OFFENCE WHERE THEY DO SO IN THE KNOWLEDGE, OR WITH REASONABLE CAUSE TO BELIEVE, THAT THE EMPLOYEE IS DISQUALIFIED.

**Part 4 – Signatures** (please read guidance note 11)

**Signature of applicant or applicant's solicitor or other duly authorised agent** (see guidance note 12). **If signing on behalf of the applicant, please state in what capacity.**

<b>Declaration</b>	<ul style="list-style-type: none"> <li>• [Applicable to individual applicants only, including those in a partnership which is not a limited liability partnership] I understand I am not entitled to be issued with a licence if I do not have the entitlement to live and work in the UK (or if I am subject to a condition preventing me from doing work relating to the carrying on of a licensable activity) and that my licence will become invalid if I cease to be entitled to live and work in the UK (please read guidance note 15).</li> <li>• The DPS named in this application form is entitled to work in the UK (and is not subject to conditions preventing him or her from doing work relating to a licensable activity) and I have seen a copy of his or her proof of entitlement to work, if appropriate (please see note 15)</li> </ul>
Signature	
Date	
Capacity	

For joint applications, signature of 2<sup>nd</sup> applicant or 2<sup>nd</sup> applicant's solicitor or other authorised agent (please read guidance note 13). If signing on behalf of the applicant, please state in what capacity.

Signature	
Date	
Capacity	

Contact name (where not previously given) and postal address for correspondence associated with this application (please read guidance note 14)			
Post town		Postcode	
Telephone number (if any)			
If you would prefer us to correspond with you by e-mail, your e-mail address (optional)			

#### Notes for Guidance

1. Describe the premises, for example the type of premises, its general situation and layout and any other information which could be relevant to the licensing objectives. Where your application includes off-supplies of alcohol and you intend to provide a place for consumption of these off-supplies, you must include a description of where the place will be and its proximity to the premises.
2. In terms of specific regulated entertainments please note that:
  - Plays: no licence is required for performances between 08:00 and 23.00 on any day, provided that the audience does not exceed 500.
  - Films: no licence is required for 'not-for-profit' film exhibition held in community premises between 08.00 and 23.00 on any day provided that the audience does not exceed 500 and the organiser (a) gets consent to the screening from a person who is responsible for the premises; and (b) ensures that each such screening abides by age classification ratings.
  - Indoor sporting events: no licence is required for performances between 08.00 and 23.00 on any day, provided that the audience does not exceed 1000.
  - Boxing or Wrestling Entertainment: no licence is required for a contest, exhibition or display of Greco-Roman wrestling, or freestyle wrestling between 08.00 and 23.00 on any day, provided that the audience does not exceed 1000. Combined fighting sports – defined as a contest, exhibition or display which combines boxing or wrestling with one or more martial arts – are licensable as a boxing or wrestling entertainment rather than an indoor sporting event.
  - Live music: no licence permission is required for:
    - a performance of unamplified live music between 08.00 and 23.00 on any day, on any premises.
    - a performance of amplified live music between 08.00 and 23.00 on any day on premises authorised to sell alcohol for consumption on those premises, provided that the audience does not exceed 500.

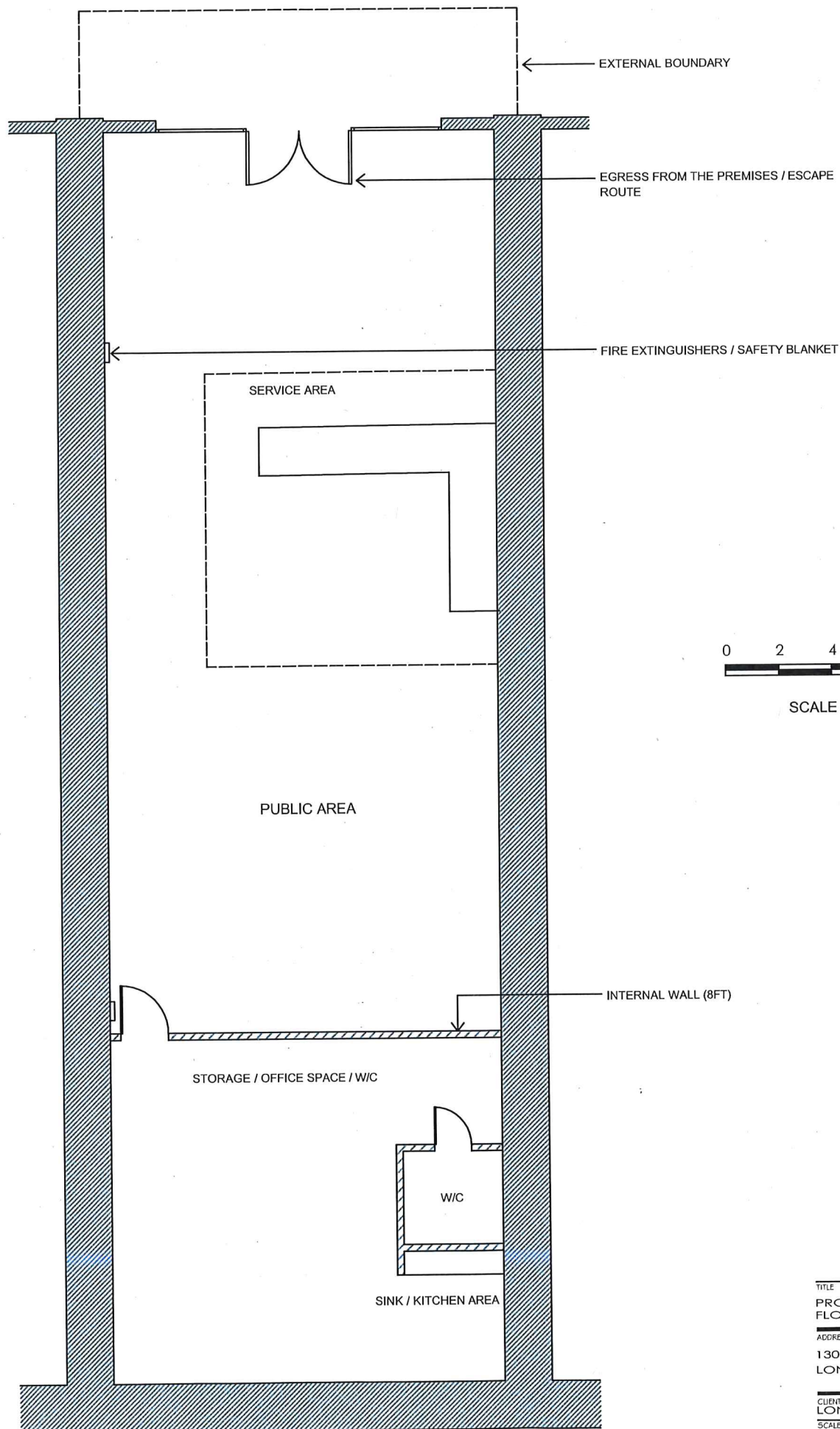

SCALE BAR ~ 1:100

TITLE		
PROPOSED GROUND FLOOR PLAN		
ADDRESS		
130 DRUID STREET LONDON SE1 2HH		
CLIENT		
LONDON CITY RUNNERS		
SCALE	DATE	
1:100	JUNE 2018	
DRAWING No.	REV.	
0001-01		

PUBLIC HIGHWAY

PARKING AND LOADING AREA

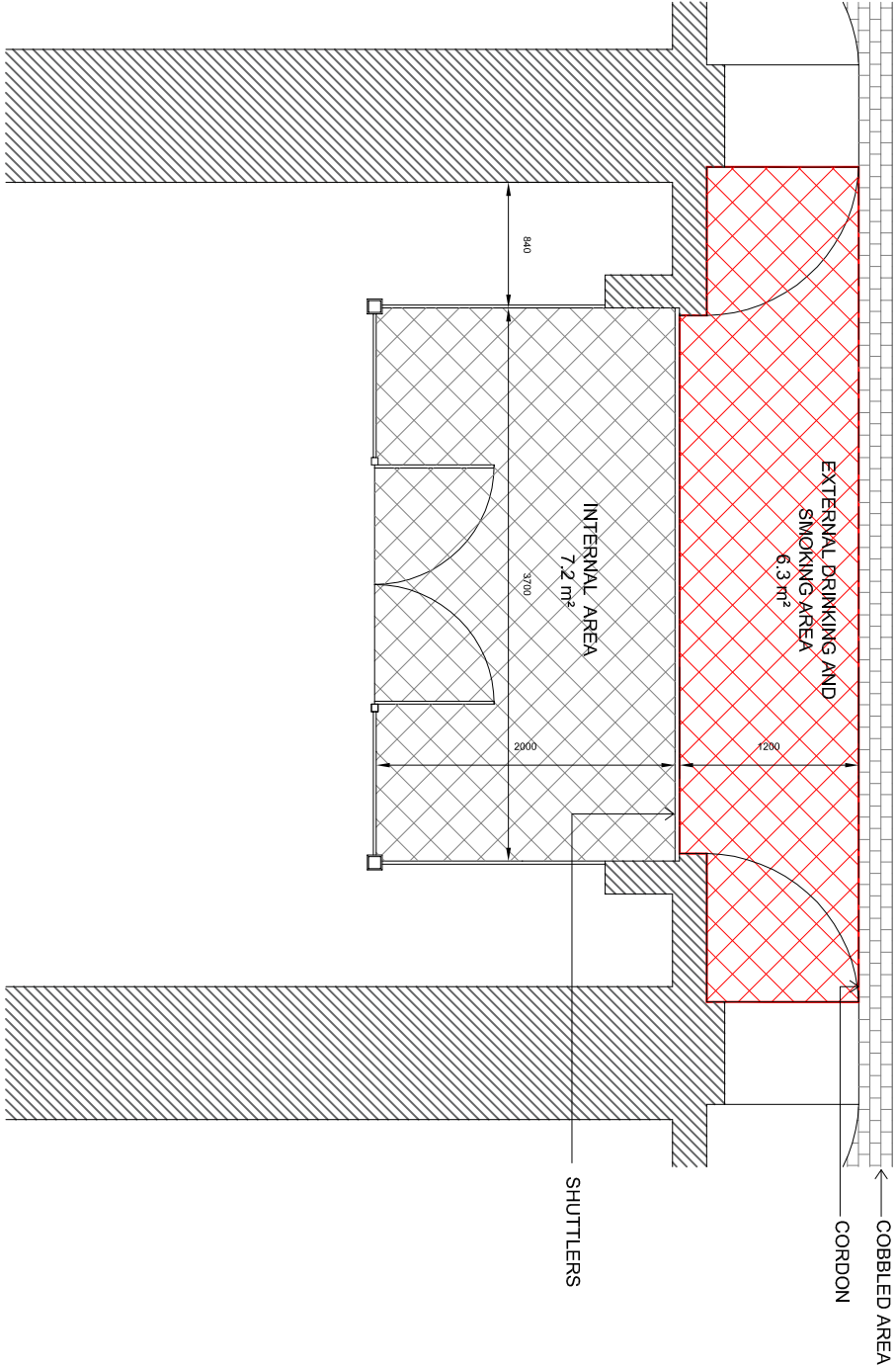

TITLE		
PROPOSED ENTRANCE		
FLOOR PLAN		
ADDRESS		
130 DRUID STREET		
LONDON SE1 2HH		
CLIENT		
LONDON CITY RUNNERS		
SCALE		
1:50	DATE	JULY 2018
0002-02	REV.	